

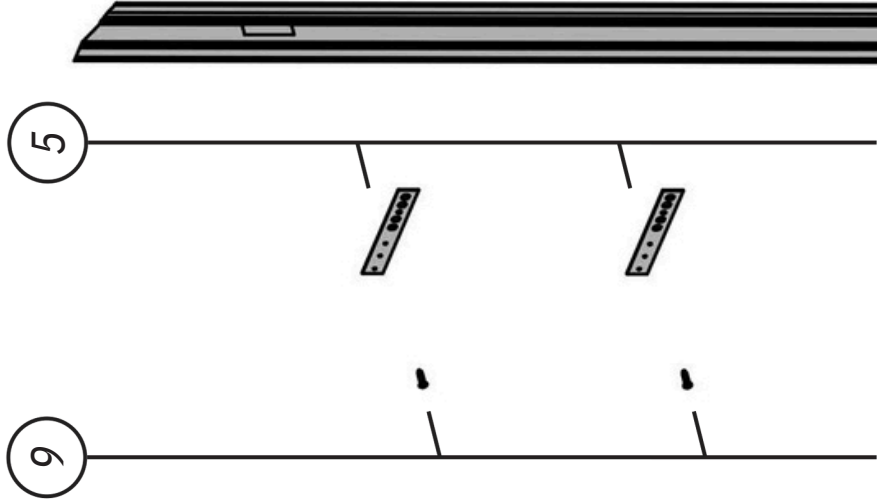

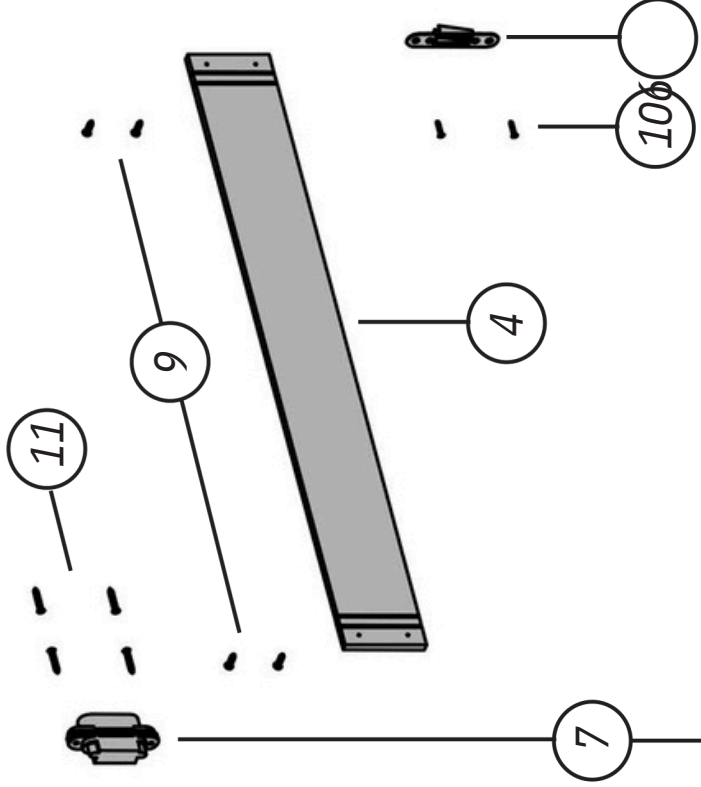

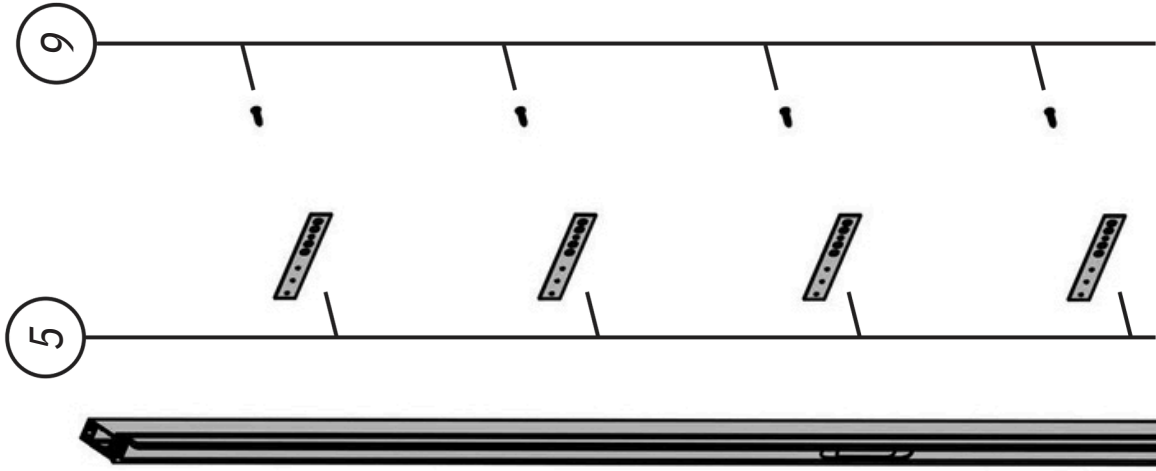

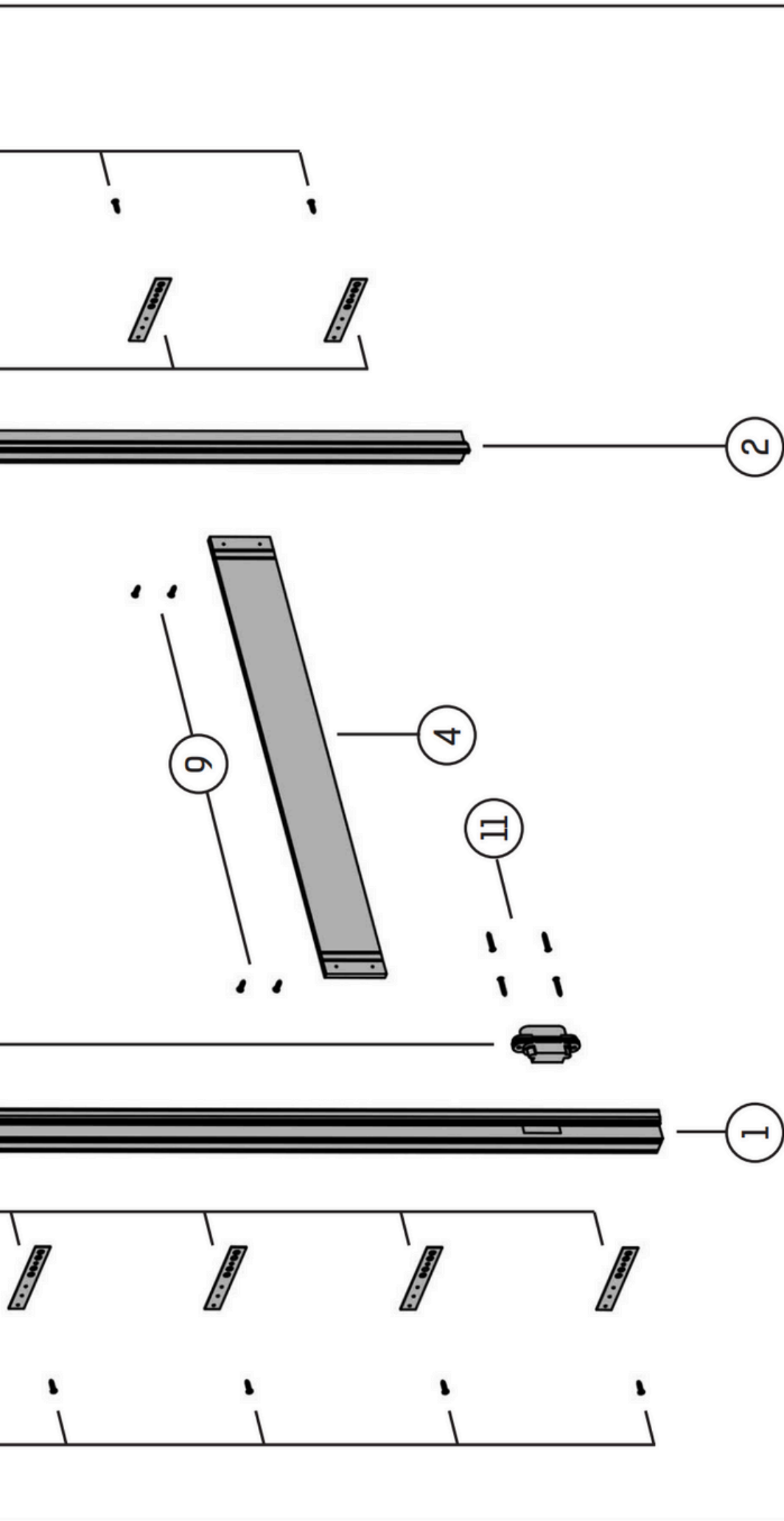







PVC 01

Paigaldusjuhend
COMPLETE PVC'40
avanemine sissepoole





1.		x1	5.		x13	9.		4,5x25 X21	*13.		x1
2.		x1	6.		x1	10.		3,5x22 X2	*14.		x3
3.		x1	7.		x2	11.		4,5x35 X8			
4.		x2	8.		4,1x55 X6	12.					x1

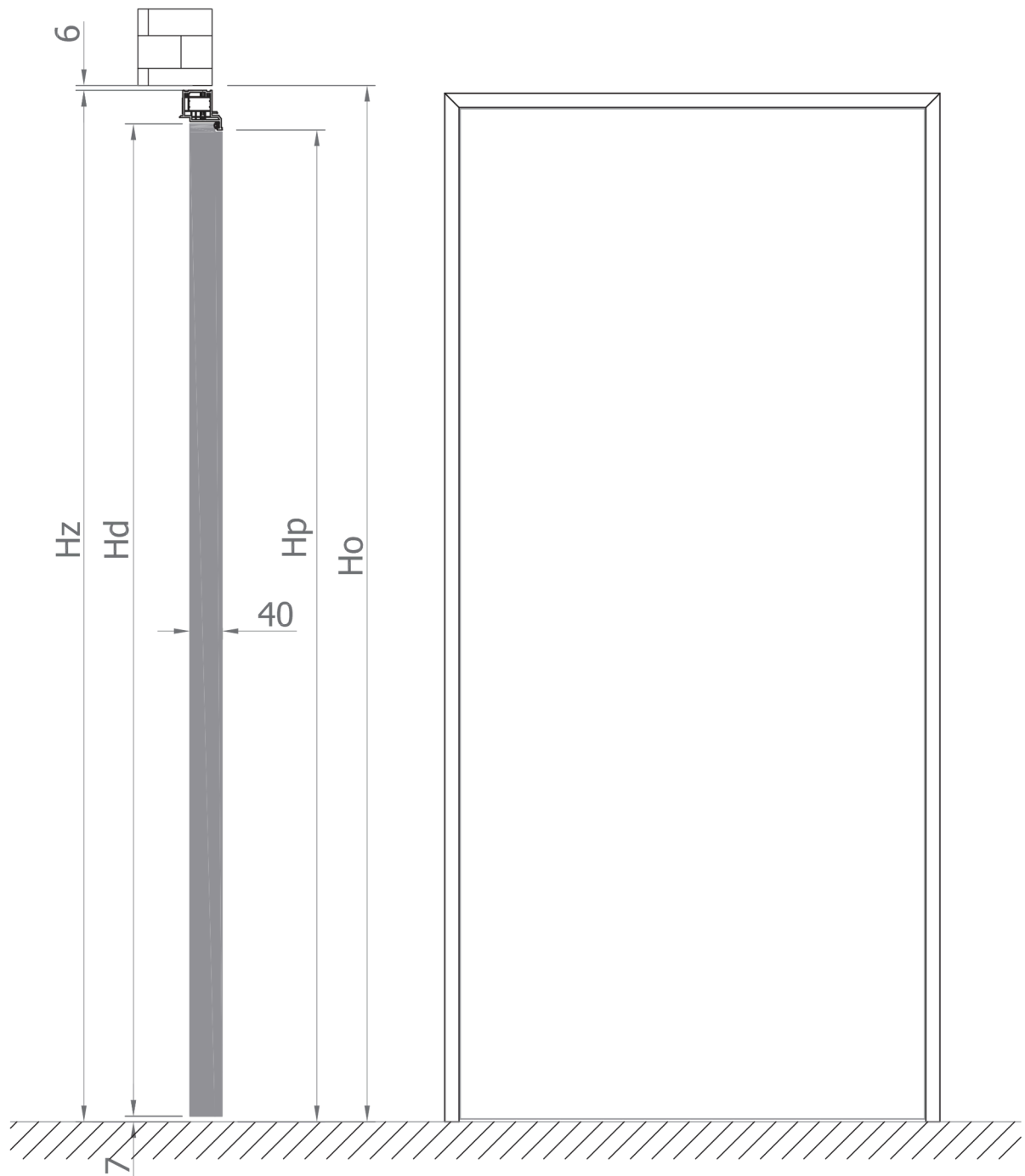

[mm]	Sd	Sp	Sz	So
70'	700	685	783	800
80'	800	785	883	900
90'	900	885	983	1000

[mm]	Hd	Hp	Hz	Ho
200'	2030	2030	2079	2085

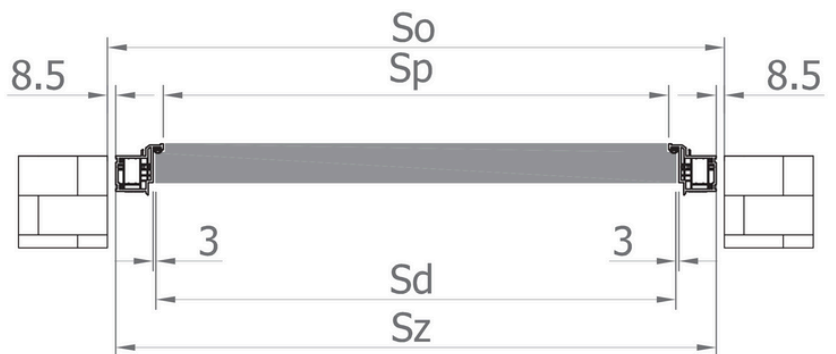

Toote standardmõõtmete skeem

[1]

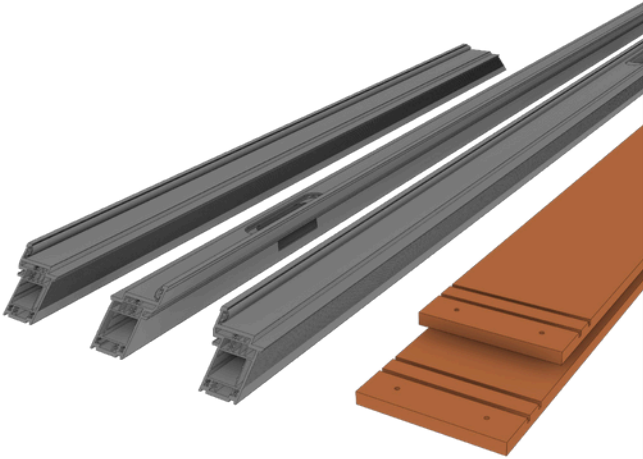

Pakkimata raami elemendid

[2]

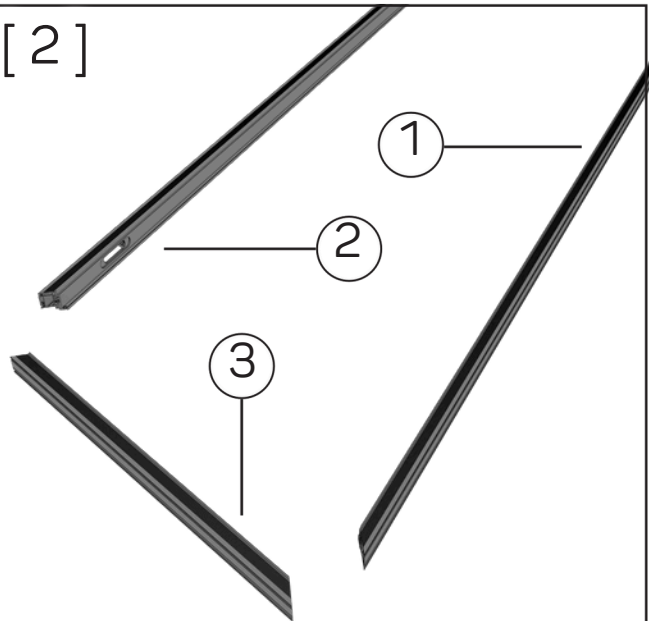

Asetage raamiprofiilid tasasele alusele

[3]

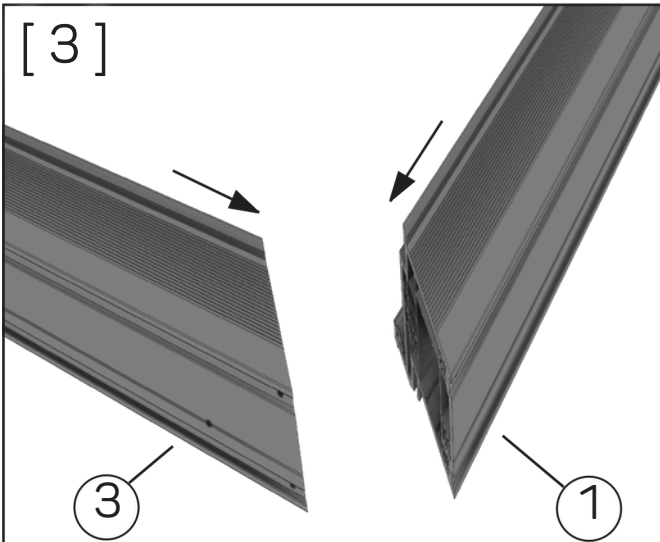

Murdke profiilide nurgad kokku

[4]

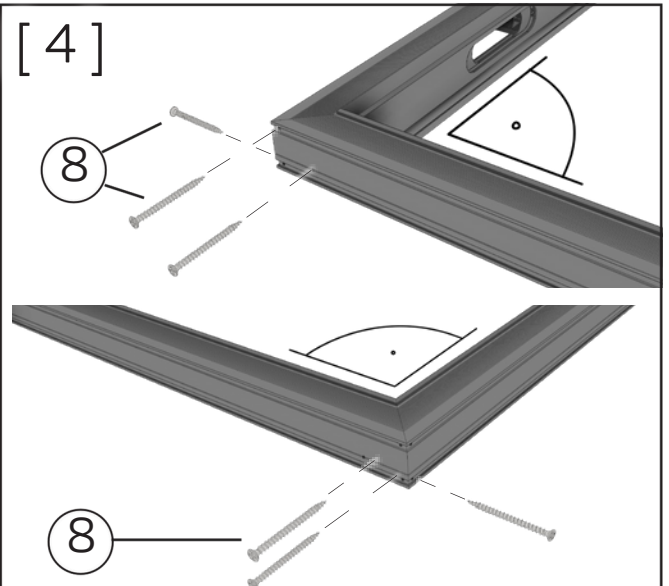

Ühendage nurgad omavahel, keerates kruvid [8] vaheldumisi ettevalmistatud aukudesse.

[5]

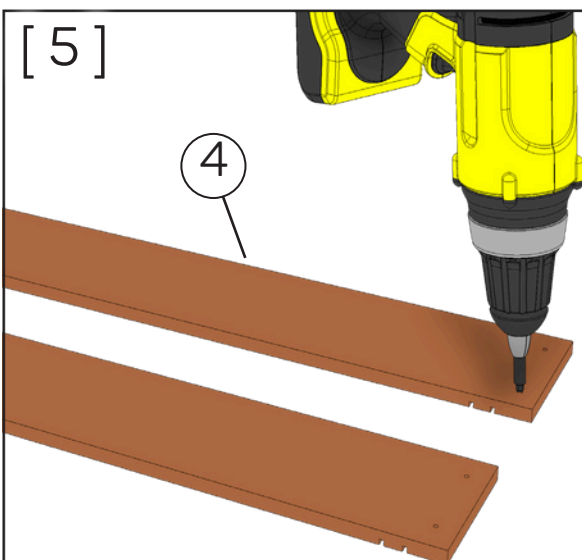

Puurige tugilaudade otstesse fi3 augud profiilide külge kruvimiseks.

[6]

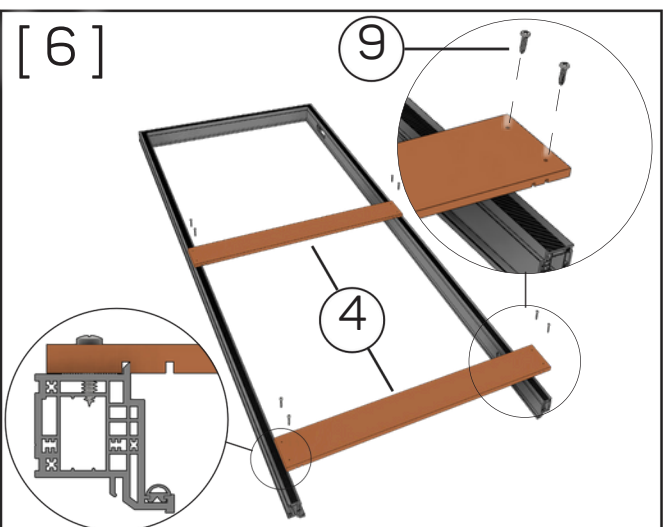

Paigaldage tugiplaadid profiili tagaküljel olevatesse süvenditesse ja pingutage seejärel kruvidega [9]. Kontrollige, et profiilide vahekaugused oleks ühtlaselt kogu raami ulatuses.

[7]

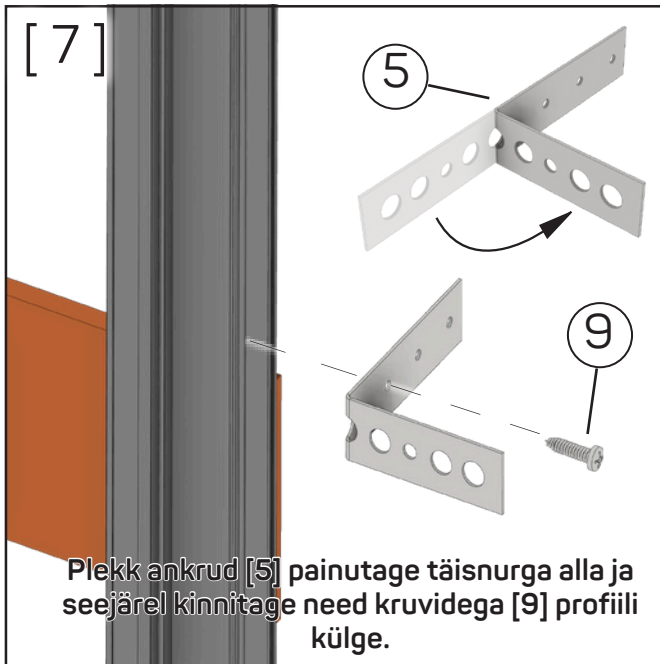

Plekk ankrud [5] painutage täisnurga alla ja seejärel kinnitage need kruvidega [9] profiili külge.

[8]

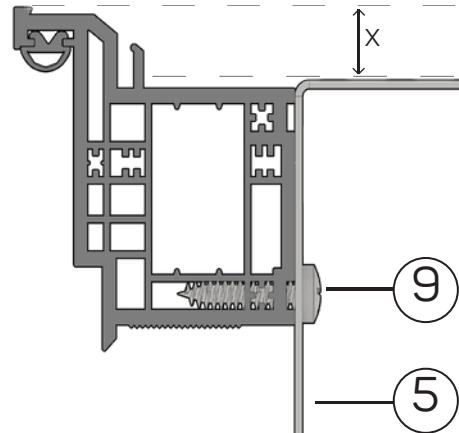

Ankrud tuleb paigutada nii, et pärast nende seinale kruvimist jäetakse ruumi katta profiil krohvi või kipsplaadiga

[9]

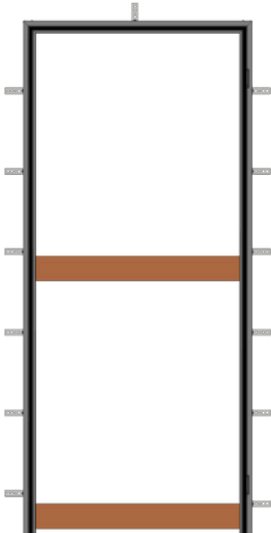

Ankrud peaksid olema ühtlaselt paigutatud. Hingede juures peaks üks ankur olema üleval, ja teine lenki all, et tagada parem tugi.

[10]

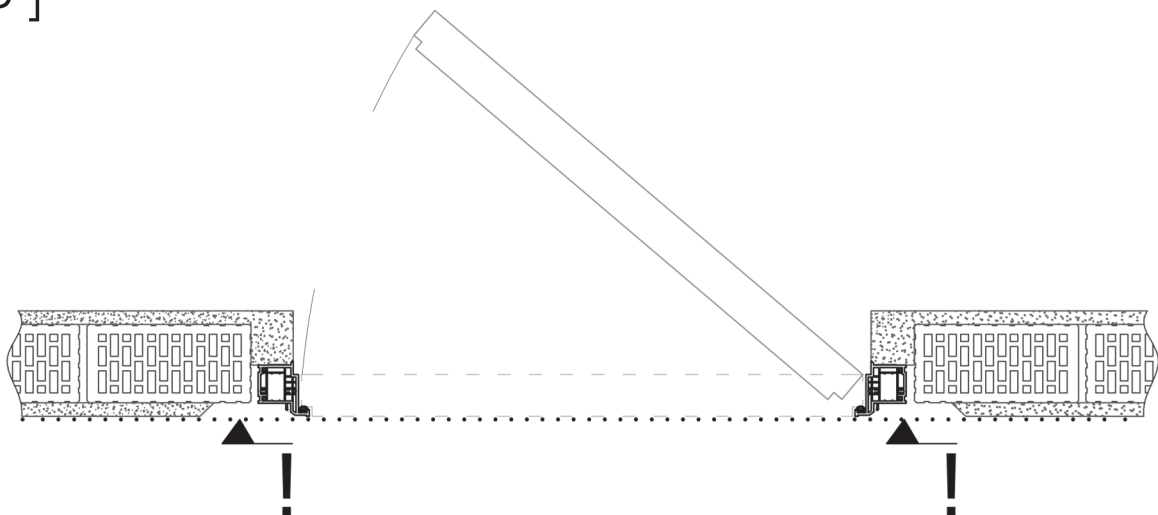

Skeem raami paigutamiseks seinale - pange tähele raami õiget asendit seina suhtes.

Paigaldamine müüritise sisse

[11a]

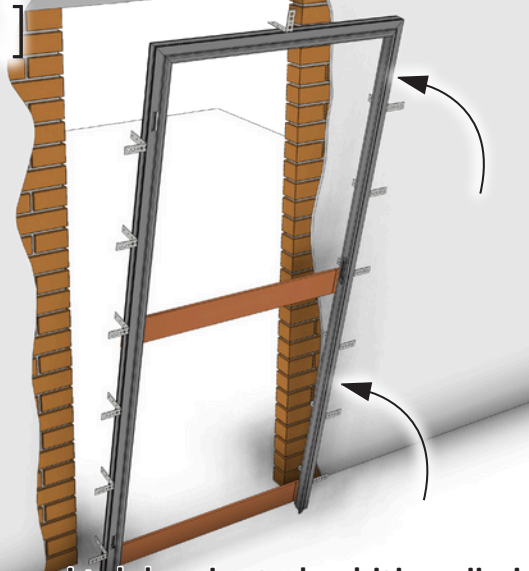

Raami tuleb paigutada ehitise viimistlemata avasse, et raami saaks seina külge kinnitada.

Paigaldamine kipsplaadist seina

[11b]



[12a]

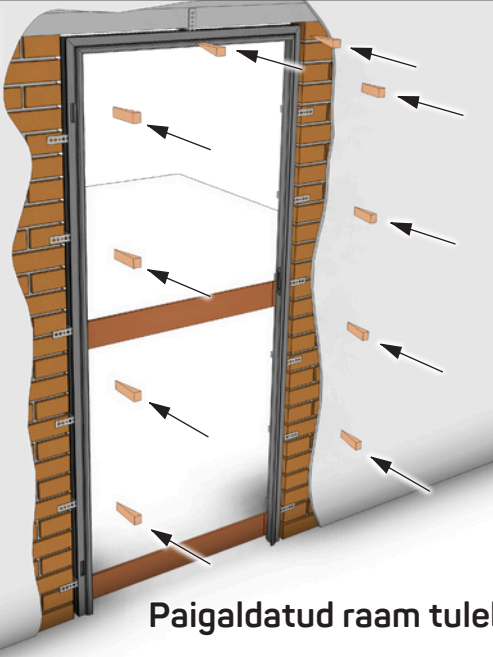

Paigaldatud raam tuleb eelnevalt avasse fikseerida.

[12b]

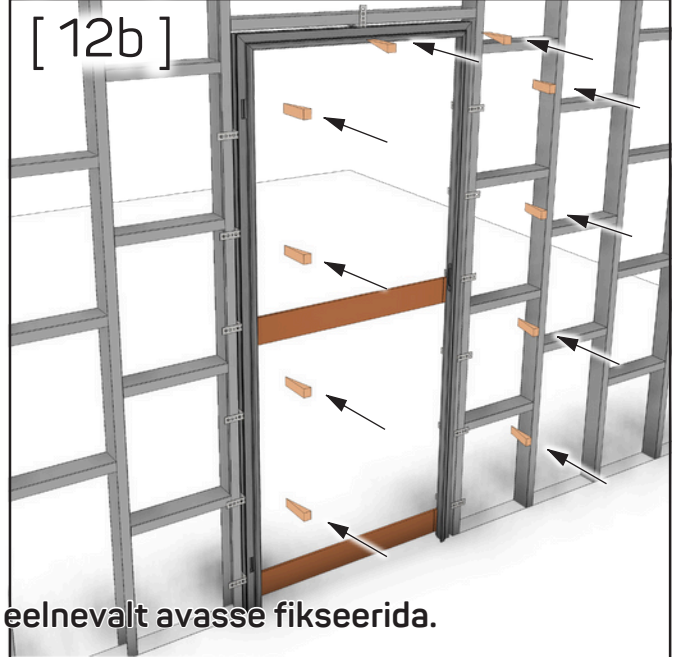

[13a]

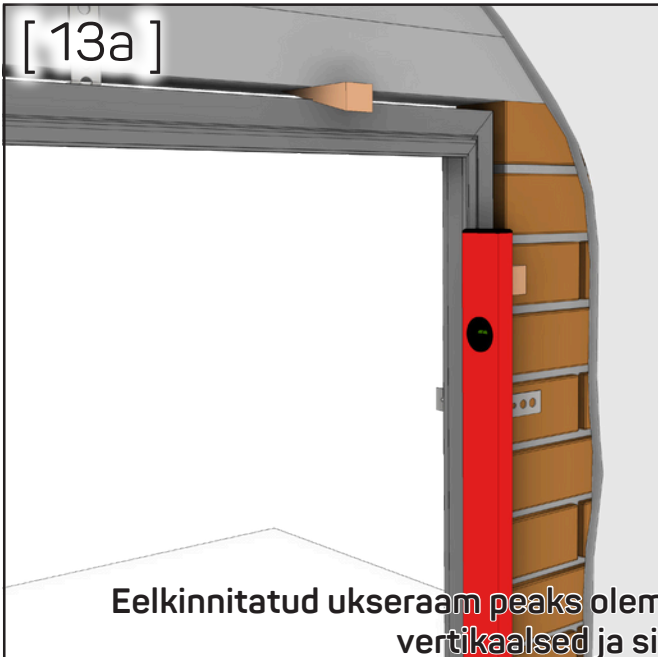

Eelkinnitatud ukseraam peaks olema tasandatud – profiilid peavad olema vertikaalsed ja sillus horisontaalsed.

[13b]

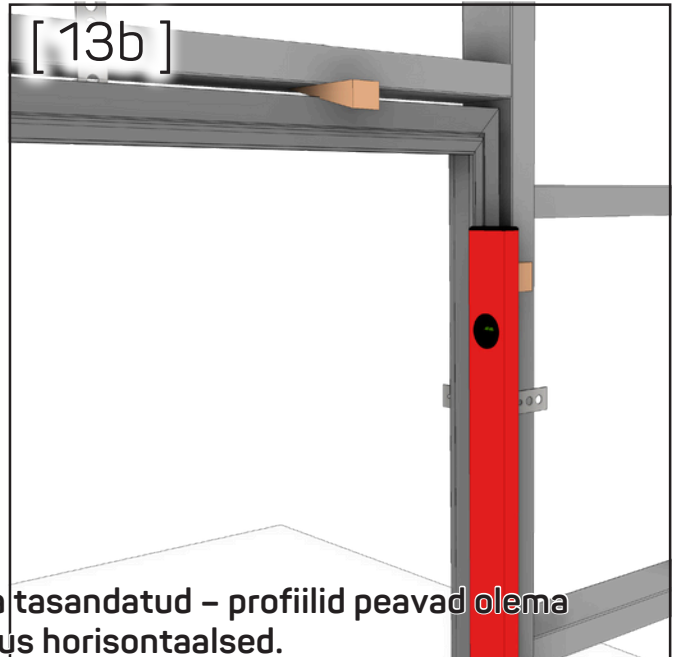

[14a]

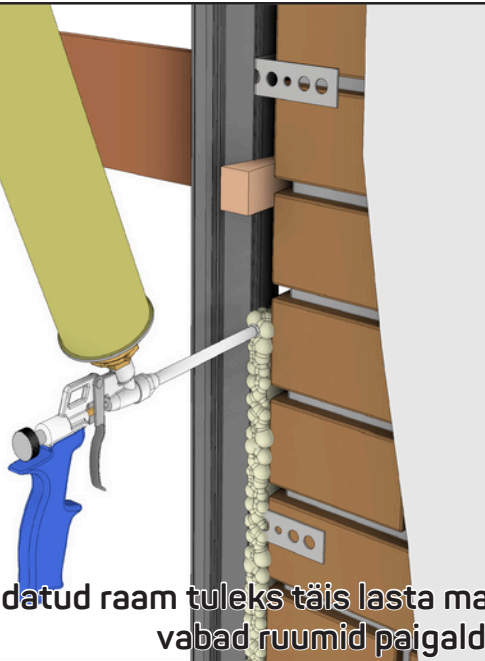
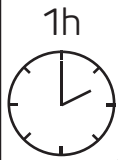

Paigaldatud raam tuleks täis lasta madala rõhuga montaažvahuga, täites kõik vabad ruumid paigaldusava ja profiilide vahel.

[14b]

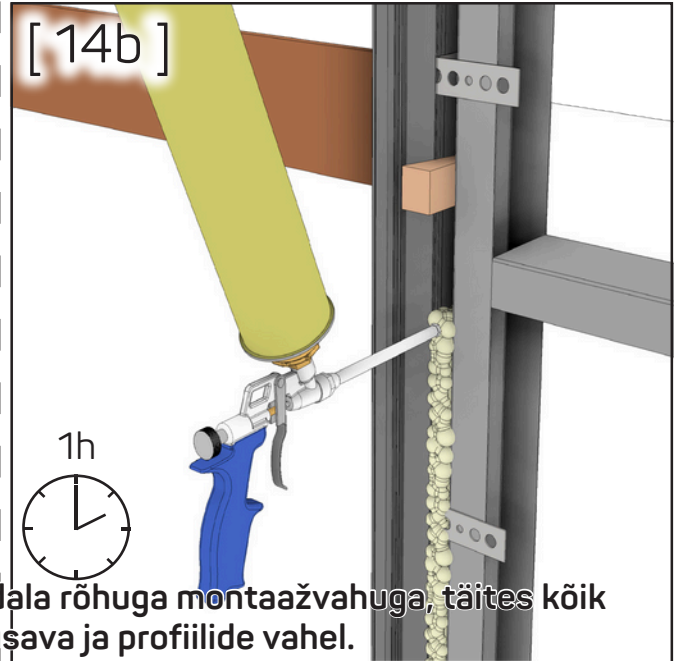

[15a]

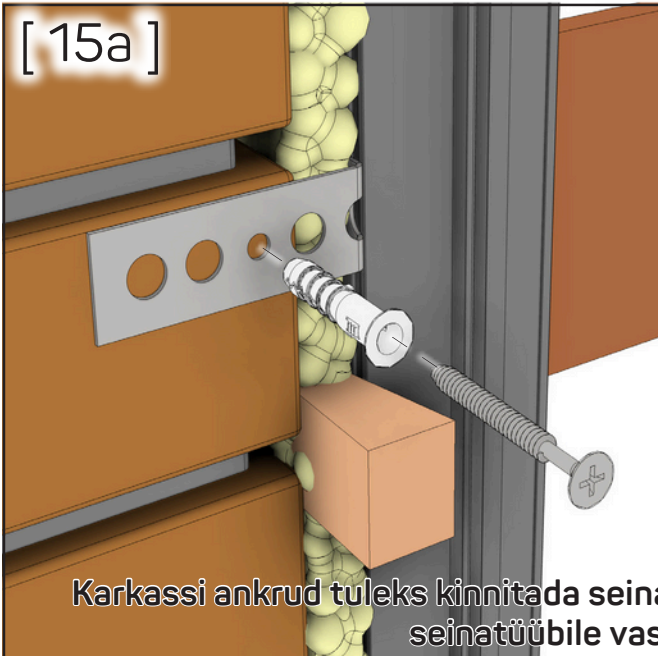

Karkassi ankrud tuleks kinnitada seinakonstruktsiooni külge, kasutades antud seinatüübile vastavat tüüblit/kruvi

[15b]

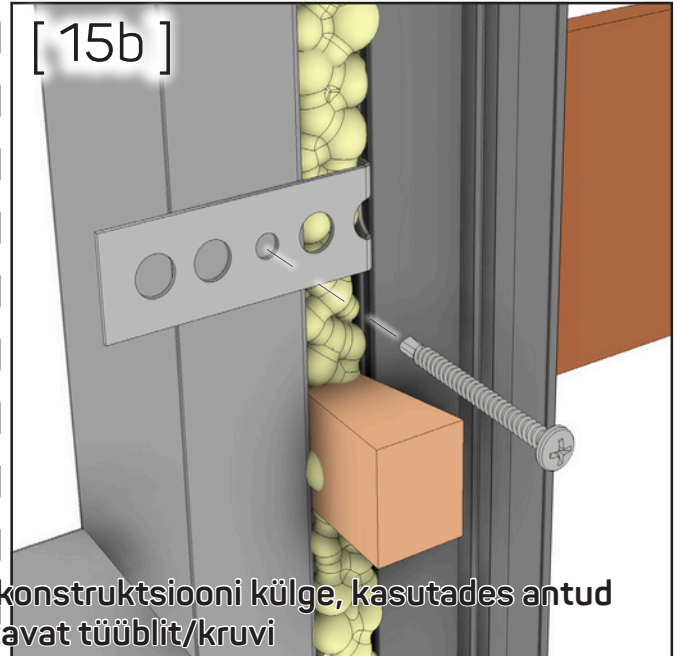

[16a]

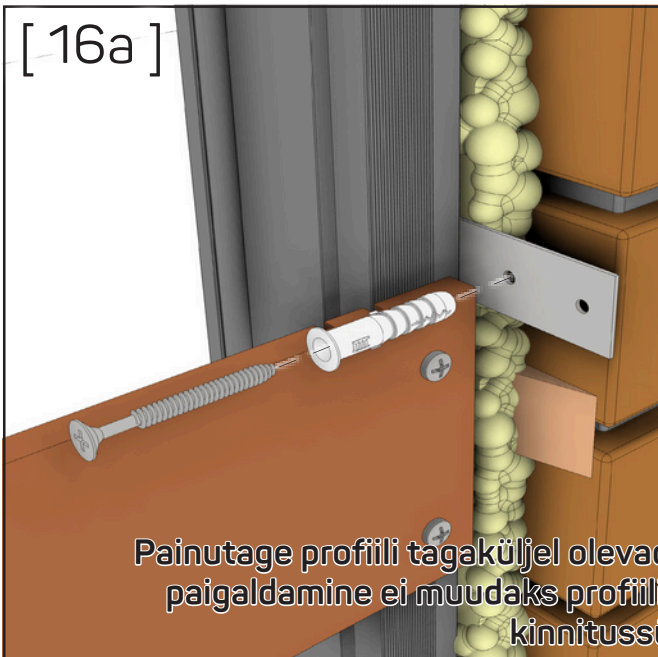

Painutage profiili tagaküljel olevad ankrud või kasutage seibi, et nende paigaldamine ei muudaks profiili asendit. Seejärel kinnitage sobiva kinnitussüsteemi abil.

[16b]

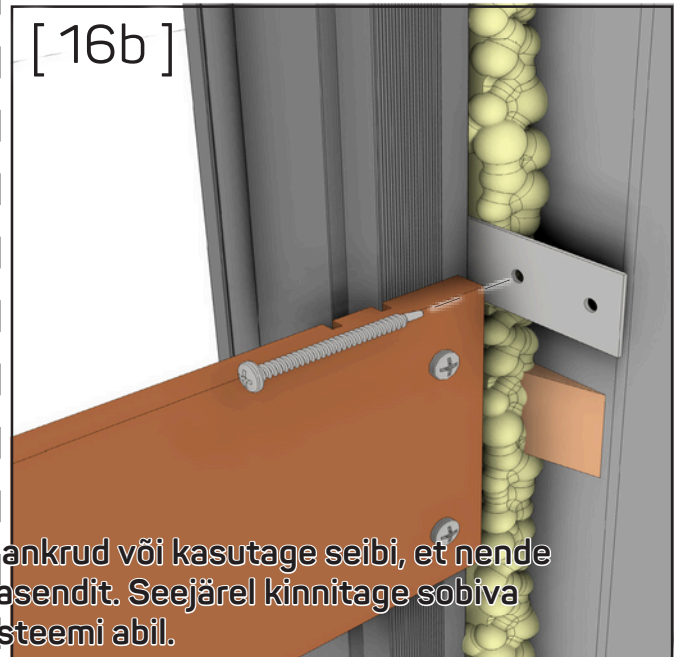

[17b]

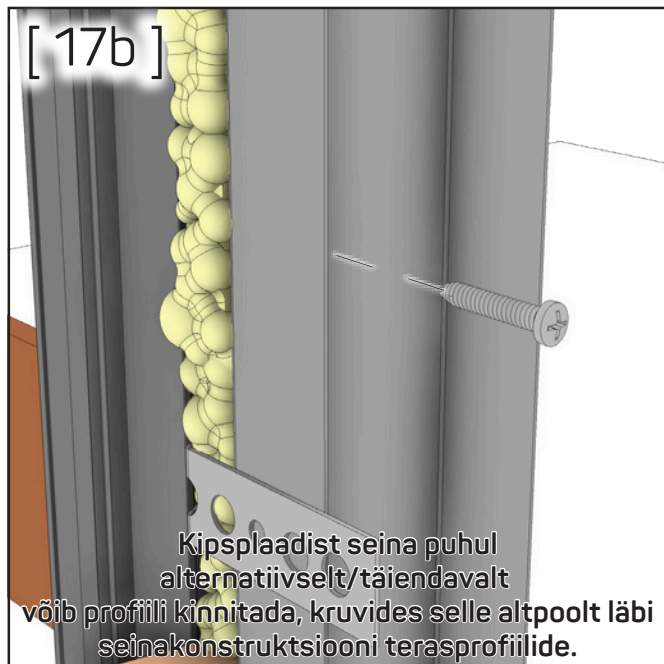

Kipsplaadist seina puhul
alternatiivselt/täiendavalt
võib profiili kinnitada, kruvides selle altpoolt läbi
seinakonstruktsiooni terasprofiilide.

[18a]

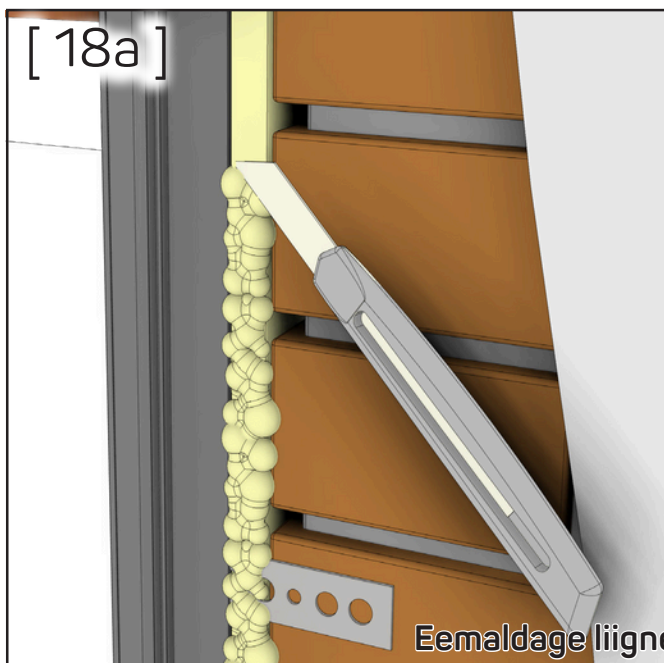

Eemaldage liigne kuiv montaaživaht

[18b]

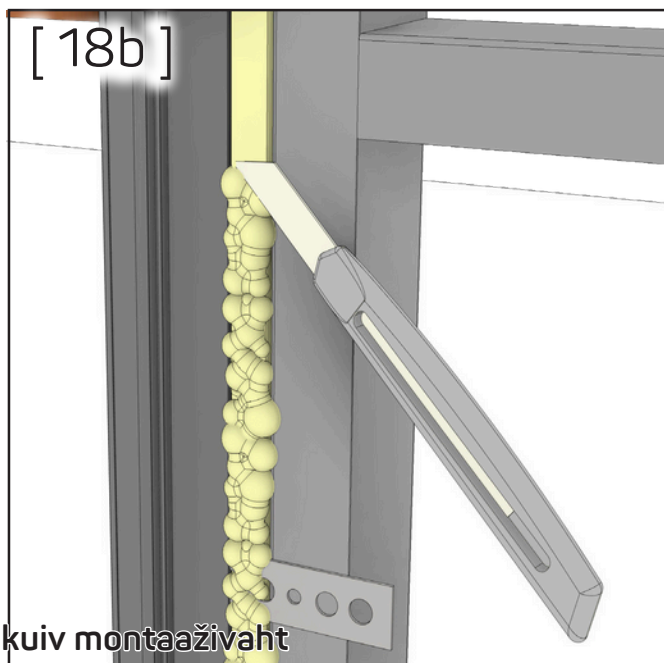

[19a]

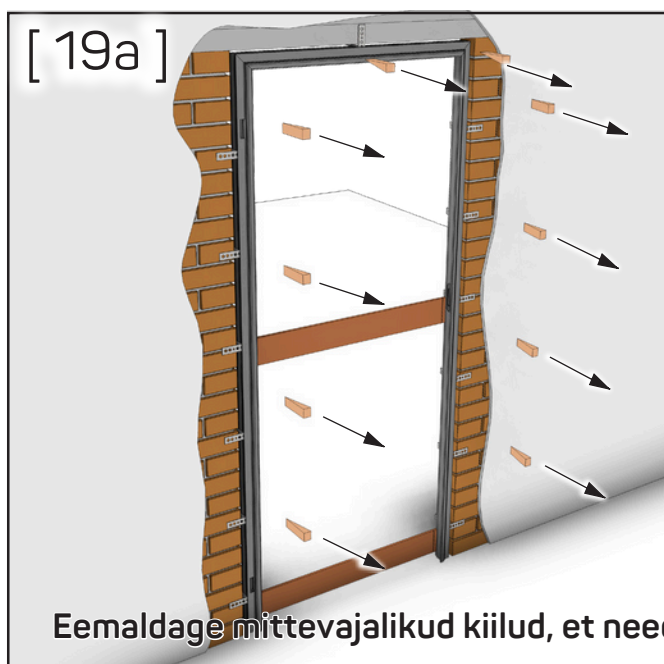

Eemaldage mittevajalikud kiilud, et need ei takistaks edasist raami paigaldamist.

[19b]



[20b]



Kruvige kipsplaadid
seinakonstruktsiooni külge.

[21a]

Ehituskeem
profiil
telliskiviseinas



min. 75 mm

[21b]

Kipsplaadist
seinaprofiili
paigalduskeem

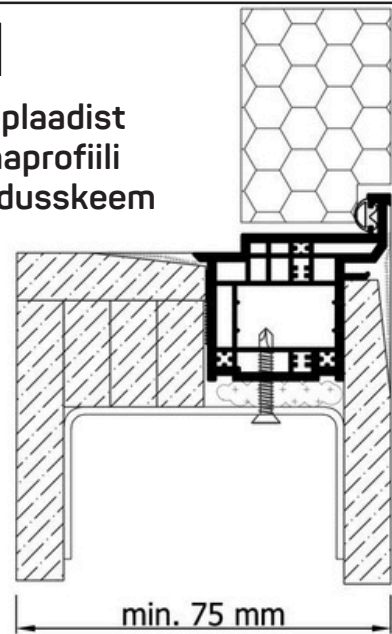

min. 75 mm

[22a]

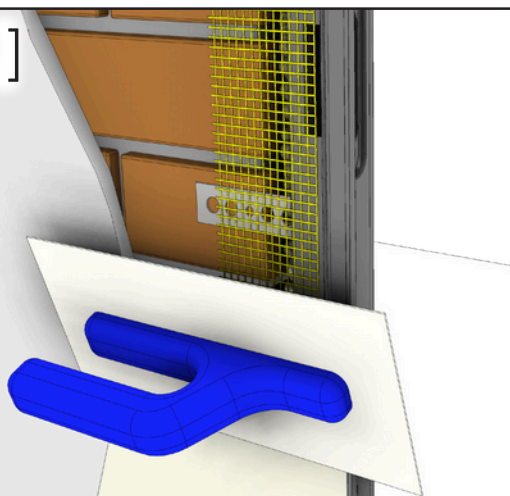

Ukseraami ühendamiseks seinaga
kasutage varjatud võrku ja seejärel katke
kõik krohviga

[22b]

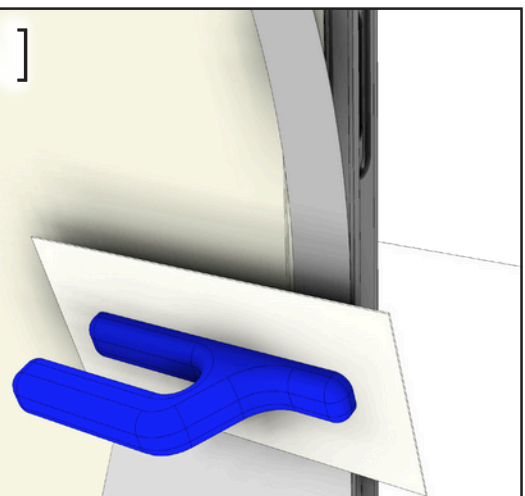

Raami ühendamiseks kipsplaatidega
kasutage vuugivõrku või -villa ja seejärel
katke kõik pahtliga.

[23a]

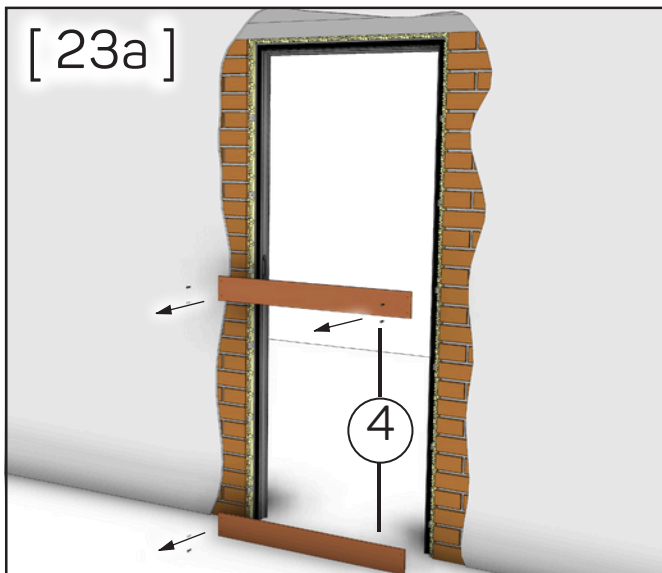

Keerake lahti ja tõmmake välja tugiplaadid, seejärel viimistlege seina sellel pool raami, analoogselt punktiga 22

[23b]

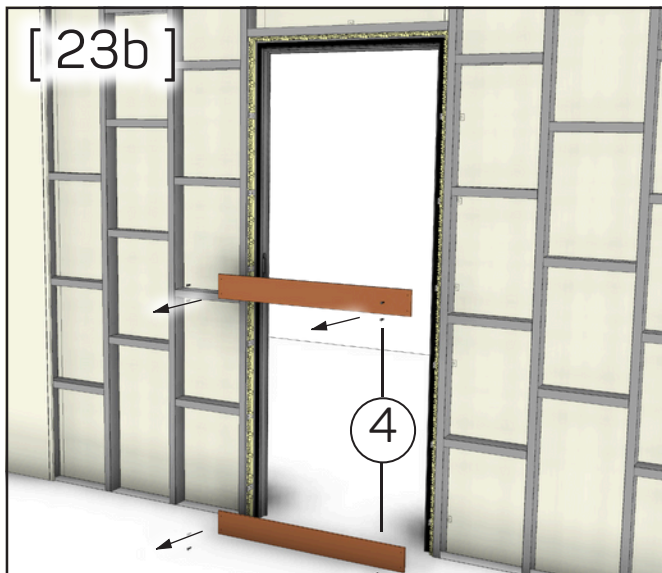

[24*]

Ainult värvimiseks mõeldud ukseraamile

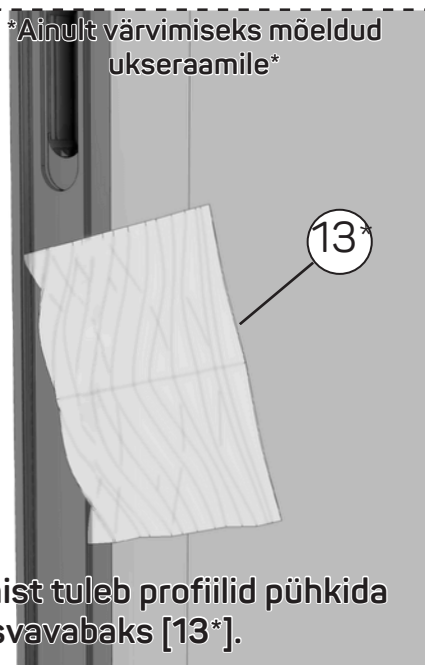

Enne värvimist tuleb profiilid pühkida rasvavabaks [13*].

[25*]

Ainult värvimiseks mõeldud ukseraamile

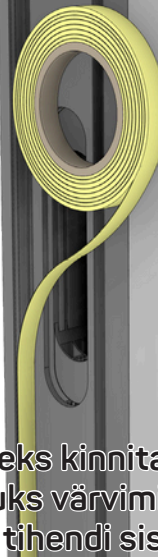

Tihendipesa tuleks kinnitada teibiga, et see ei määrduks värvimise ajal, mis raskendaks tihendi sisestamist.

[26*]

Tylko dla ościeżnicy przeznaczony do malowania

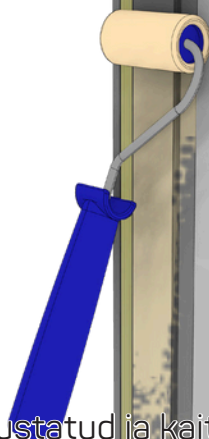

Rasvatustatud ja kaitstud profiil värvitakse sama värviga, mis sein. Olge ettevaatlik, et te ei kataks hingede pesasid ja kaitseplaati värviga.

[27]



Valmis seina värvima

[28*]

Ainult ukseraamile, mis on ette nähtud ülevärvimine*

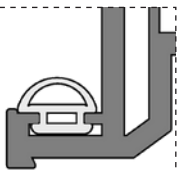

Pärast profiilide värvimist ja kaitselindi eemaldamist sisestage tihend [14*] selleks ettenähtud pilusse. !Tihend on asümmeetriline!

[29]

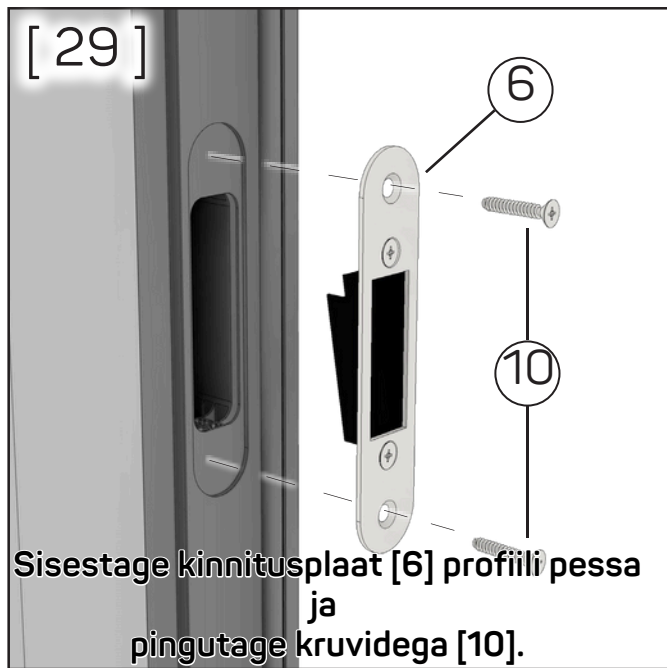

Sisestage kinnitusplaat [6] profiili pesa ja pingutage kruvidega [10].

[30]

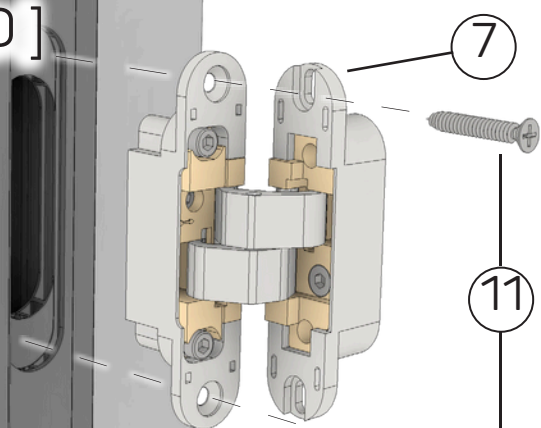

Sisestage hinged [7] profiilis olevasse pesa ja pingutage need kruvidega [11]. ! Hing peaks sobituma lõdvalt pesasse - eemalda pesast kipsilt igasugune mustus!

[31]

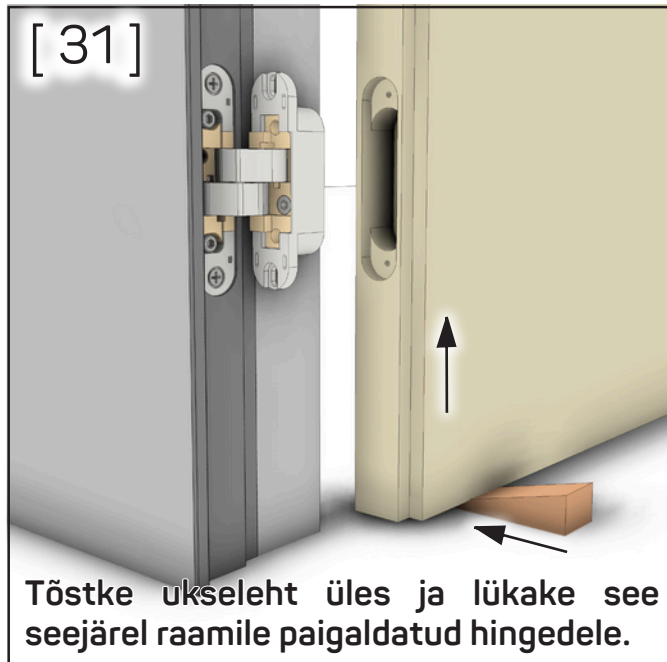

Tõstke ukseleht üles ja lükake see seejärel raamile paigaldatud hingedele.

[32]

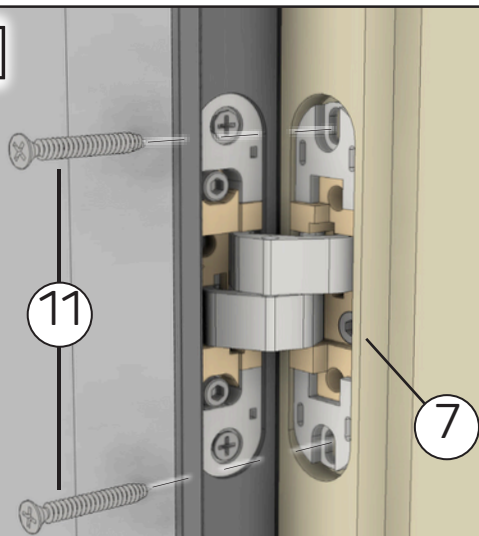

Pärast lengi asetamist hingedele [7] pingutage need kruvidega [11].

[33]

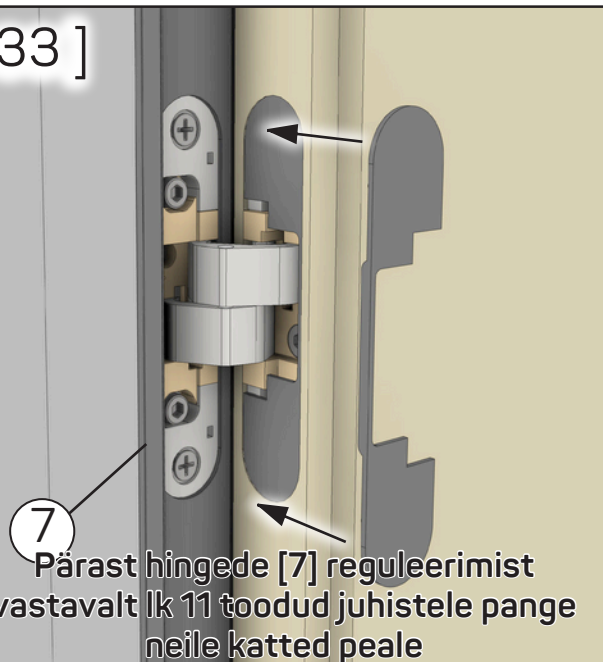

Pärast hingede [7] reguleerimist vastavalt lk 11 toodud juhistele pange neile katted peale

[34]

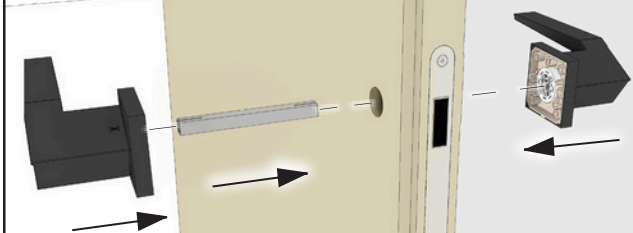

Pärast ukselehe paigaldamist saate paigaldada käepideme

[35]



Paigaldatud ja viimistletud ukseraam

Reguleerimisjuhised standardse standardsed hinged

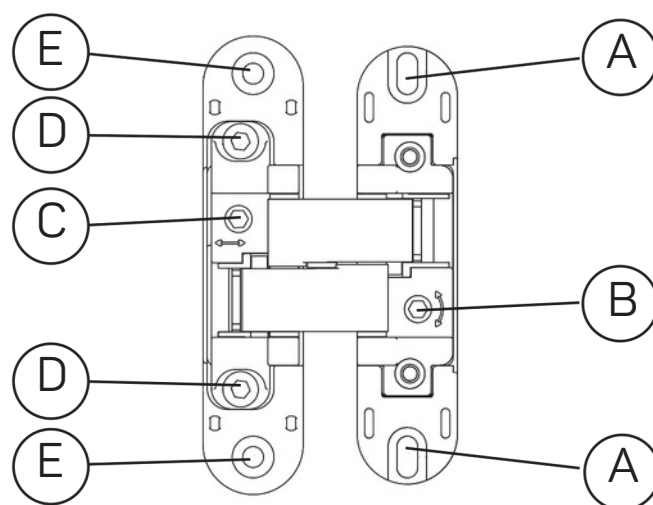

A - ovaalne ava hingede kinnitamiseks lengi külge ning selle reguleerimiseks üles- ja allapoole. (ülalpool asetseva vahe kompenseerimine)

B - kruvi hingede paremale ja vasakule reguleerimiseks (külgmiste vahede kompenseerimine).

C - kruvi hingede reguleerimiseks ette- ja tahapoole (korpuse ja seinapinna joondamine).

D - kruvi kruviga C reguleeritud asendi avamiseks/lukustamiseks

E - ümmargune ava hingede kinnitamiseks raami külge

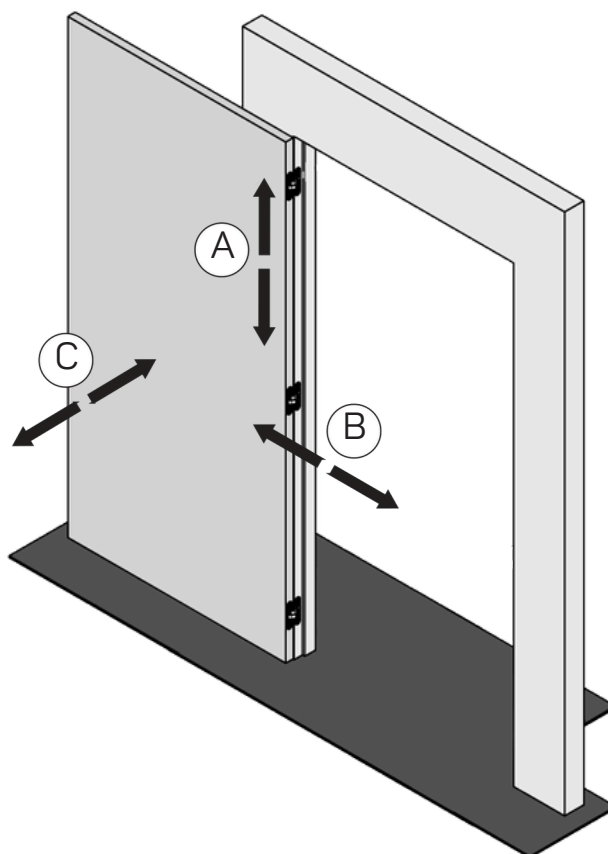

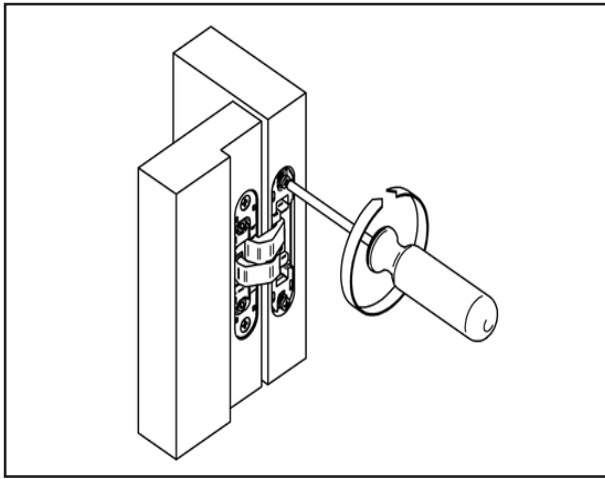

1. Lehtede kõrguse reguleerimiseks (ülemise pilu vähendamiseks või suurendamiseks) keerake kruvid lahti aukudes [A] hoides aknas kõiki hingesid.

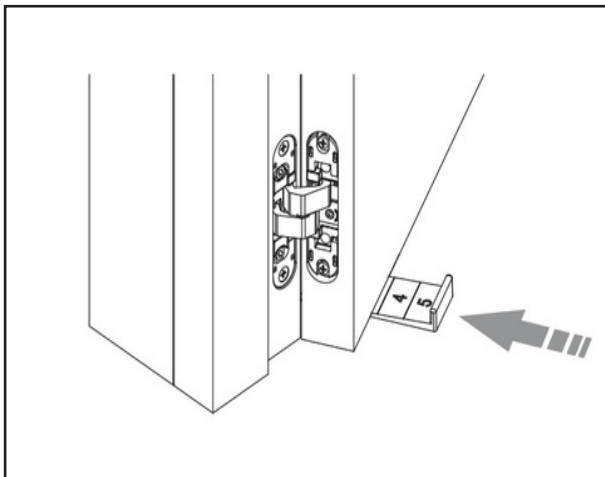

2. Kasutades kiilu (ukse reguleerimisseib), tõstame ukse sobivale kõrgusele, nii et lengi ja lehe vahe oleks ligikaudu 3 mm.

Seejärel pingutame kõik hinged lehe külge. Hinge reguleerimisvahemik on **5 mm** selle alumisest asendist

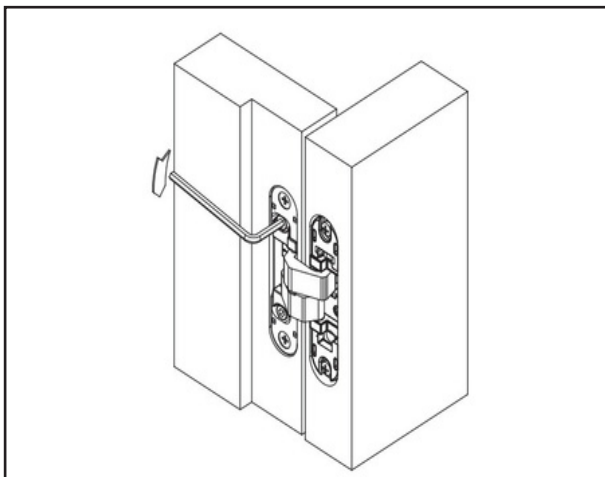

3. Selleks, et reguleerida tiiba nii, et selle pind on seina pinnaga samal tasemel, esmalt tuleb kruvid [D] lahti keerata.

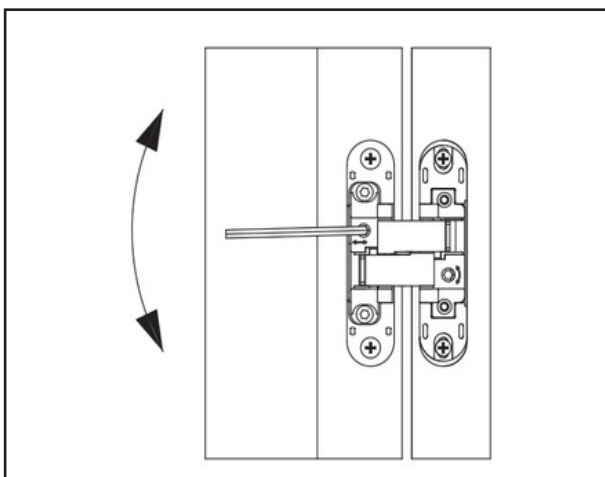

4. Seejärel, keerates kruvi [C] paremale või vasakule, nihutame lehte raamile lähemale või kaugemale.

Pärast hingede õiget reguleerimist sellel tasapinnal pingutage asendi lukustamiseks kruvid [D] uuesti.

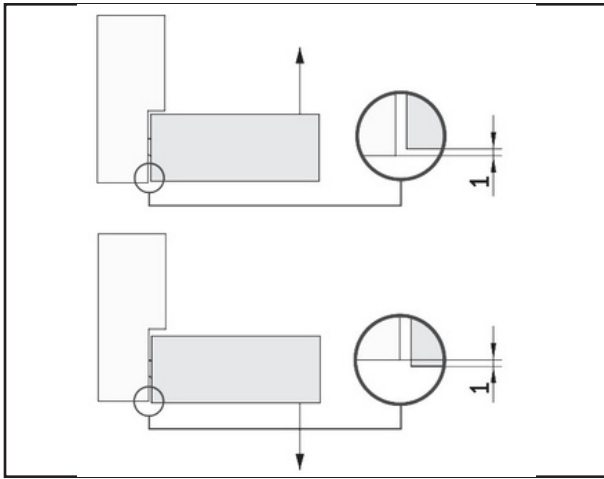

Hinge reguleerimise vahemik sellel tasapinnal on: **+/-1 mm.**

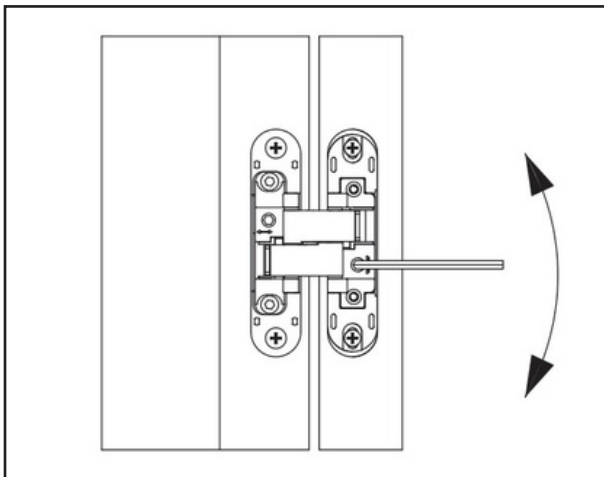

5. Lehe ja raami vahede reguleerimiseks külgedel pingutage või vabastage hinges olev kruvi [B], mis põhjustab lehe liikumise paremale või vasakule.

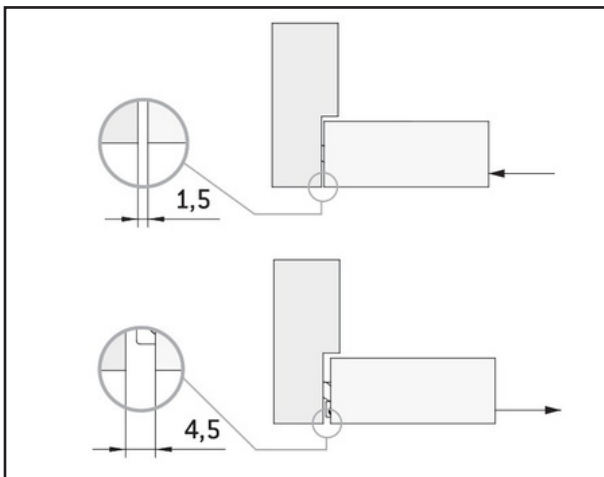

Hinge reguleerimise vahemik sellel tasapinnal on: **+/-1,5 mm.**

Kahjustuste vältimiseks reguleerige kõik hinged ühtlaselt nii, et ükski neist ei oleks ülekoormatud.



 | **PROME**



INFO@PROME.EE



TALA 2, TALLINN



+372 5477 0566